

# How to Add a Slidebox

## 1. When to Use a Slidebox

Once you've uploaded some slides and created at least one collection, you can create a slidebox. A slidebox allows you to group and organize your collections. Some use cases for slideboxes include: organising all collections from one hospital for pathologists with multiple residencies; or organising multiple timepoints in a longitudinal study.

## 2. Walkthrough

1. Go to "slidebox" in the sidebar

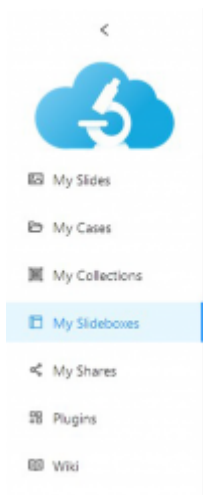

2. Click on "+ New slidebox" in the middle of the page

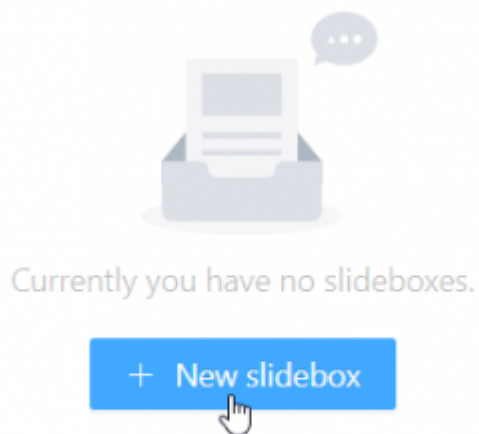

3. Choose a name for your slidebox and click on "Create".

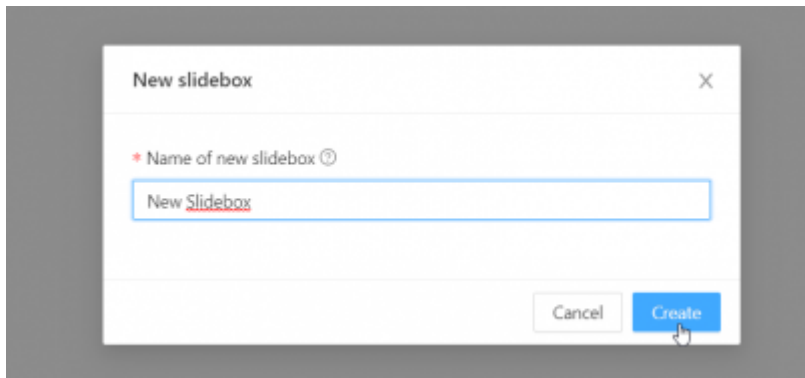

4) Select the content which you want to add to your slidebox and press “>”.

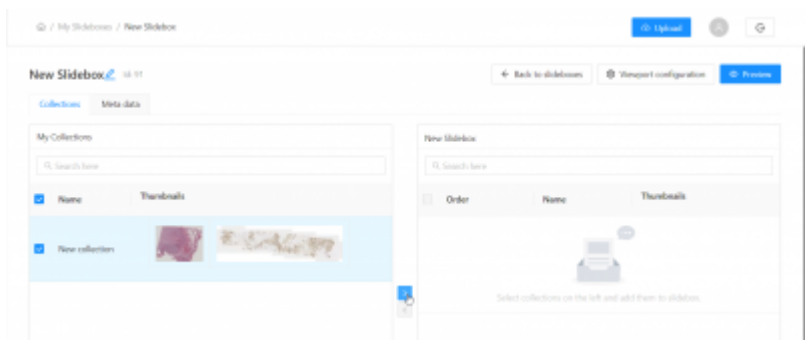

- You can also add meta-data to your slidebox



5) With My Pathomation, you can configure your viewport, the way you want it. Click on “viewport configuration” to choose how people can look at your slides.

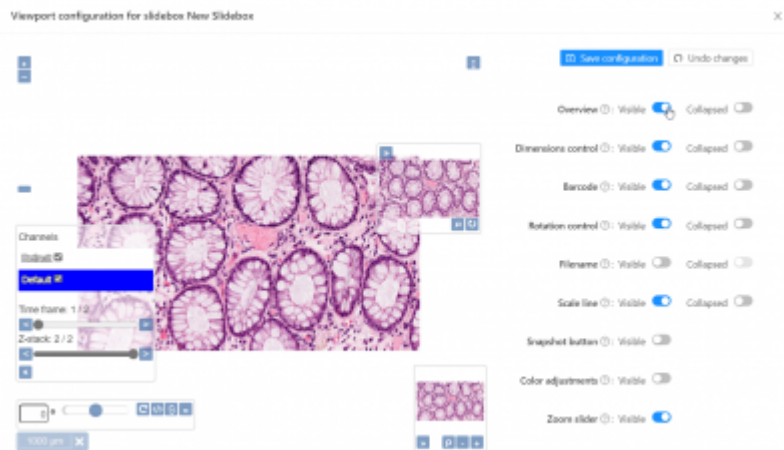

6) Return to the list, by using the “Back to slideboxes” button, or preview your newly created slidebox by clicking on “Preview” button.

Test  Id: 68

[← Back to slideboxes](#)



[⚙ Viewport configuration](#)

[👁 Preview](#)

[Collections](#) [Meta data](#)

My Collections

🔍 Search here

<input type="checkbox"/>	Name	Thumbnails
<input type="checkbox"/>	Collection 1	
<input type="checkbox"/>	4744	
<input type="checkbox"/>	Collection	

Test

🔍 Search here

<input type="checkbox"/>	Order	Name	Thumbnails
<input type="checkbox"/>	▼ ▲	Test	

From: <https://docs.pathomation.com/my/> - **My Pathomation**

Permanent link: [https://docs.pathomation.com/my/doku.php?id=how\\_to\\_add\\_a\\_slidebox&rev=1699534954](https://docs.pathomation.com/my/doku.php?id=how_to_add_a_slidebox&rev=1699534954)

Last update: **2023/11/09 16:02**

