







Windows

- Extract file PMA.transfer.2.2.0.103.zip into a destination folder
- Navigate to destination folder

 msvcr100.dll	8/26/2020 1:59 AM	Application extension	809 KB
 packager.dll	8/26/2020 1:59 AM	Application extension	287 KB
 PMA.transfer.exe	8/26/2020 1:59 AM	Application	115 KB
 PMA.transfer.ico	8/26/2020 1:59 AM	Icon	98 KB
 ucrtbase.dll	8/26/2020 1:59 AM	Application extension	979 KB
 vcruntime140.dll	8/26/2020 1:59 AM	Application extension	86 KB

- Double click on file PMA.transfer.exe

MacOS

- Double click on file PMA.transfer.2.2.0.103.dmg
- The disk image gets mounted and you get prompted with the following window

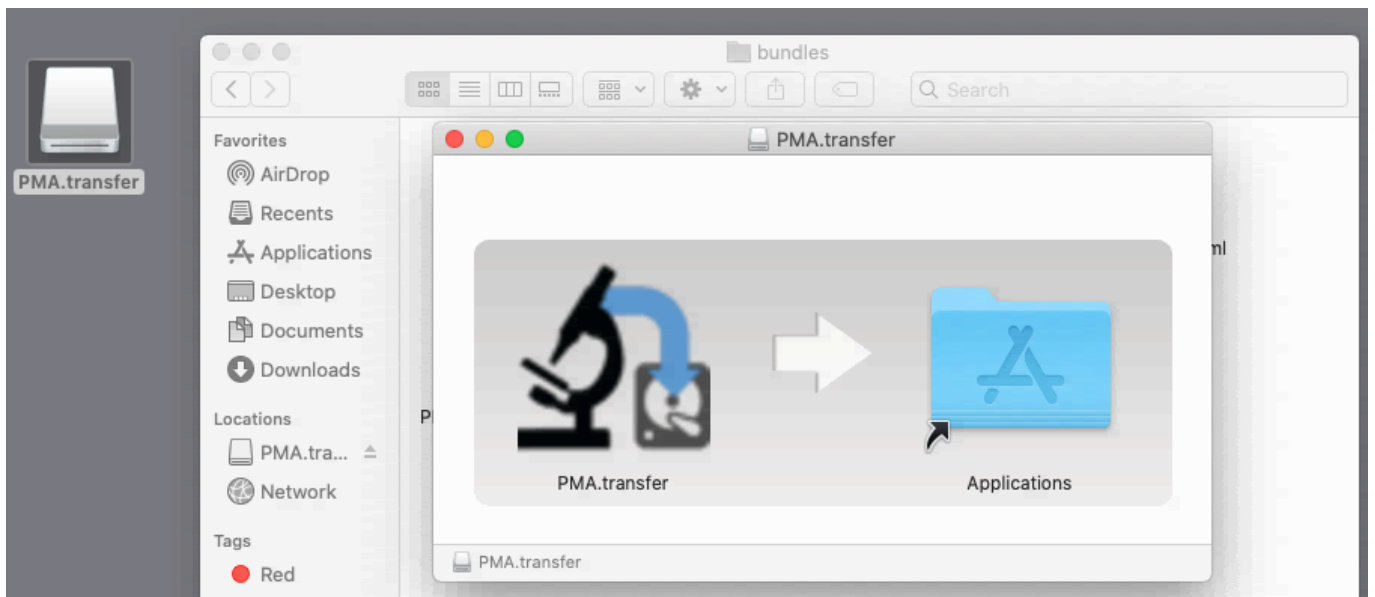

- Double click on PMA.transfer icon to launch the app

From:
<https://docs.pathomation.com/pma.transfer/> - **PMA.transfer**

Permanent link:
<https://docs.pathomation.com/pma.transfer/doku.php?id=installation&rev=1598921334>

Last update: **2020/09/01 03:48**

